

CHAINS

ESTABLISHED CORNERS FOR OREGON STATE BOARD OF FORESTRY
 (See official plat)
 West One Sixteenth corner common to Sections 6 and 7,
 T1S, R7W, W.M., Tillamook County, Oregon.

ESTABLISHED

Var. 21 $\frac{1}{2}$ E

Set 1 $\frac{1}{2}$ " x 36" galvanized iron pipe with 3" bronze cap marked "OREGON STATE BOARD OF FORESTRY W 1/16 S6 S7 1958 RS401", 33 inches in ground, in mound of stone, and from which a:

- 70" Fir stump bears N84W 30.2 ft.; scribed W 1/16 S6 BT.
- 77" Fir snag bears N88 $\frac{1}{2}$ E 82.9 ft.; scribed W 1/16 S7 BT RS401.

Oregon State Board of Forestry metal location poster on 77" Fir snag BT.
 Set 4" x 4" x 53" white painted Cedar post 1.0' S.E. of pipe.

Center North One Sixteenth corner for Section 7,
 T1S, R7W, W.M., Tillamook County, Oregon.

ESTABLISHED

Var. 21 $\frac{1}{2}$ E

Set 1 $\frac{1}{2}$ " x 36" galvanized iron pipe with 3" bronze cap marked "OREGON STATE BOARD OF FORESTRY N 1/16 C---C S7 1958 RS401", 33 inches in ground, in mound of stone, and from which a:

- 60" Fir stump bears S21E 30.0 ft.; scribed CN 1/16 S7 BT RS401.
- 4" Fir bears N 1 $\frac{1}{2}$ W 72.4 ft.; scribed X BT.

Oregon State Board of Forestry metal location poster on 60" Fir stump.

Dated December 17, 1958

Established by

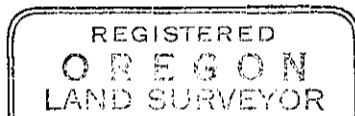

Richard A. Morris

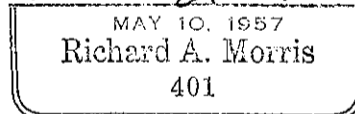

Present and witnessed by R. Cop
 R. Schulson
 H. Russell

Book I

354

354

354